

Innovations for etics, plastering and dry-lining

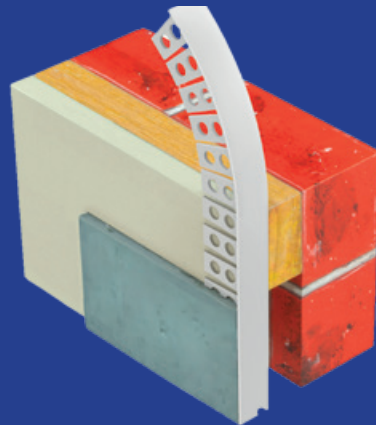

# INNOVATIONS FOR PLASTERING, DRYWALL, ETICS

Quality, precision, and sustainability:  
Our profiles set standards.



Your partner  
for innovative  
& sustainable  
solutions



[WWW.VWS.DE](http://WWW.VWS.DE)

[in /COMPANY/VWS-BEFESTIGUNGSTECHNIK-GMBH](https://www.linkedin.com/company/vws-befestigungstechnik-gmbh)



Dear customers and interested parties,

As the management of VWS, we are pleased to provide you with an insight into our company philosophy and our products.

Quality, precision, and sustainability are values that drive our company.

Innovation is the foundation of our success. We take pride in our ability to advance technological progress and creative solutions. We tirelessly work on developing new products and improving existing ones.

It is particularly worth mentioning our focus on the sustainability of our products and production processes. We commit to ethical, social, and environmentally friendly standards and contribute to protecting the world for future generations.

Our goal is to manufacture high-quality products while providing excellent customer service. Customer satisfaction is the benchmark for our actions.

We sincerely thank you for your interest and support. Your feedback and suggestions are of crucial importance to us.

Kind regards,



Karl Helmut Vollmer  
Managing Partner  
VWS Befestigungstechnik



Christian Achilles  
Executive Management  
VWS Befestigungstechnik

# CONTENT

04	ABOUT VWS
05	OUR COMMITMENT
06	SUSTAINABILITY
07	QUALITY
08	RESEARCH & DEVELOPMENT
09	PRODUCT INNOVATION
12	CUSTOMER SUPPORT
13	THE "VWS CAMPUS"
14	LOGISTICS
15	SOCIAL RESPONSIBILITY
16	OUR PROFILES

# ABOUT VWS

Since 1981, VWS, a medium-sized enterprise, has been synonymous with innovations in plastering, drywall, and external thermal insulation composite systems (ETICS). As part of the Vollmer Group, we place great emphasis on sustainability. Our long-standing expertise and technical competence make us a reliable partner.



> 40

Production sites in the European Union



3

Production sites in the European Union



> 100

Employees in the EU



> 500

various products in over 1200 variants

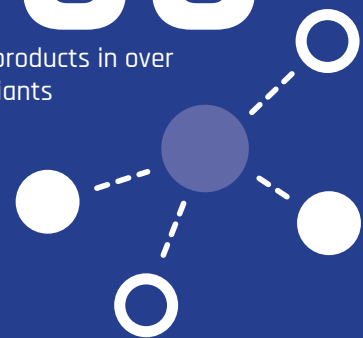

1700

satisfied customers worldwide



60 Mio.

Meters of profiles sold in 2023





# OUR COMMITMENT



## 1. Sustainability

We are committed to sustainability, for instance, by employing environmentally friendly production practices and using sustainable materials.

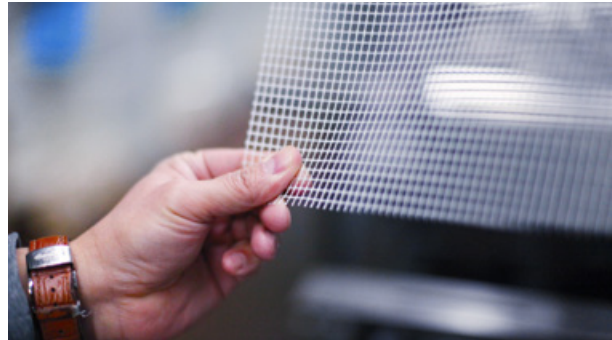

## 2. Quality

Quality is the top priority at VWS. Our products undergo strict quality controls to ensure the highest standards.



## 3. Research & Development

With cutting-edge technologies and innovative materials research, we develop new products and solutions for our customers.



## 4. Customer Support

VWS is characterized by competent care and comprehensive support. The VWS Campus offers numerous product training sessions by experts.



## 5. Logistics

Through efficient logistics and the optimization of our processes, we ensure timely deliveries with minimal costs and emissions.



## 6. Social Responsibility

The Diversity Charter is our guide for an inclusive and diverse working environment. We actively advocate for diversity and equal opportunities.

# SUSTAINABILITY



**The promotion of sustainability in construction aligns with the goals of the Vollmer Group.**

The Vollmer Group is intensifying its commitment to sustainability. This is demonstrated by setting cross-company objectives and by making significant investments in biomass and solar parks.

**VWS makes a contribution to achieving these goals. We bear responsibility for the environment and our fellow human beings. We therefore strive to make our products more environmentally friendly and durable.**



## Recycling

100% of the production waste is added to the production cycle.



## >30% Regranulate

Our products consist of over 30% regranulate.



## 100% Green electricity

We produce exclusively with green electricity.



## 100% Adhesive paper tape

We only use sustainable paper adhesive tapes.



## Sustainable materials

We rely on resource-conserving materials such as recycled raw materials.



## Deklarationen

We create EPDs (Environmental Product Declarations) for our profiles.



## Ecovadis-Rating

This year, our production facility in France received the received the bronze rating from Ecovadis.



## UN Global Compact

We are committed to ethical, social and environmental standards, for example through our participation in the UN Global Compact.

# QUALITÄT



Permanent internal  
production controls



Production quality externally  
tested (ift Rosenheim)



ISO 9001 certification  
since the year 1996



Use of high-quality and  
ecological materials

At VWS we want to develop products of outstanding  
quality that meet the highest standards. ”

Christian Achilles, VWS Management Board



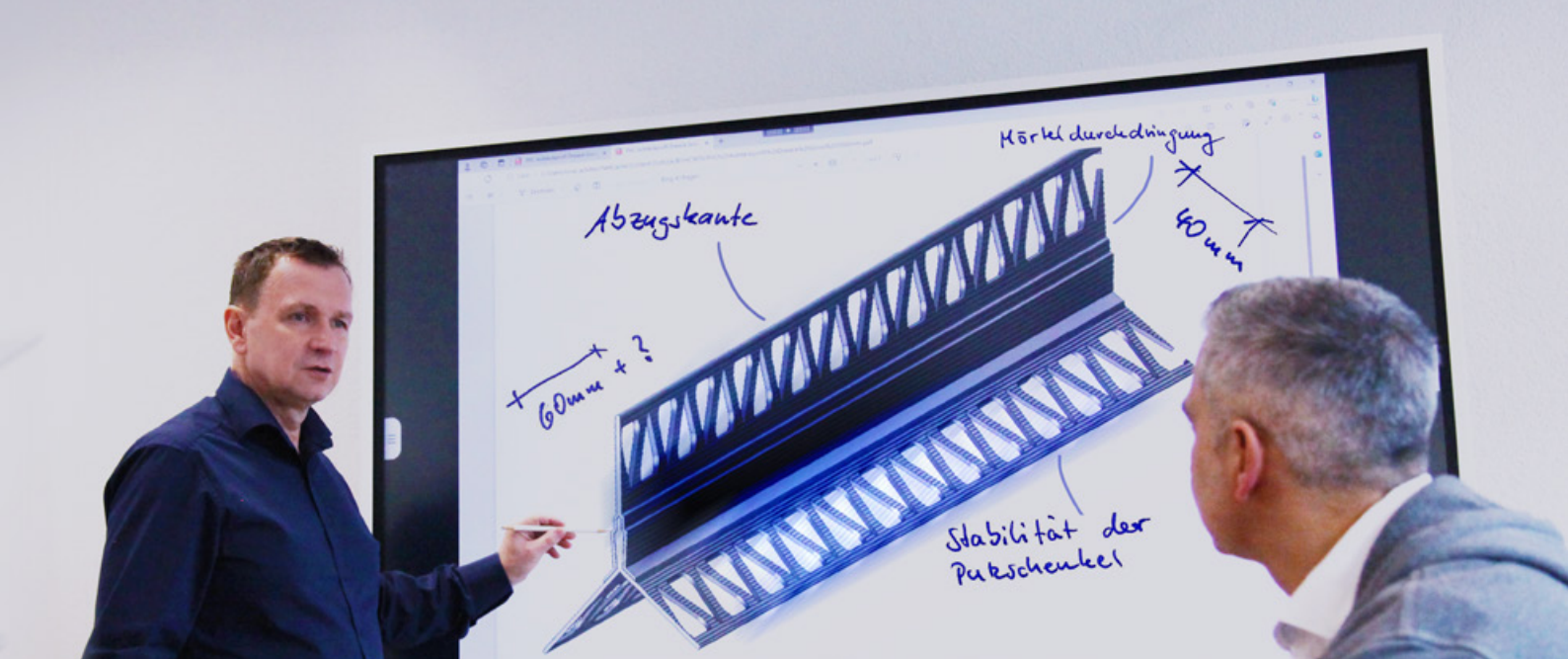

# RESEARCH & DEVELOPMENT



## Own department for Research & Development

Our research and development department utilizes cutting-edge technologies to explore new and eco-friendly materials for product development. Additionally, we prioritize automation and continuously strive to enhance our products.



## Product development with our customers

The needs and feedback of our customers are paramount in our product development process. They inspire new ideas and motivate us to create products that surpass expectations.



## The latest technical standards

At VWS, we focus on technical standards and peak performance. Through stringent quality controls and streamlined processes, we continuously elevate our products, delivering top-tier solutions for plaster, dry construction, and ETICS (External Thermal Insulation Composite Systems).

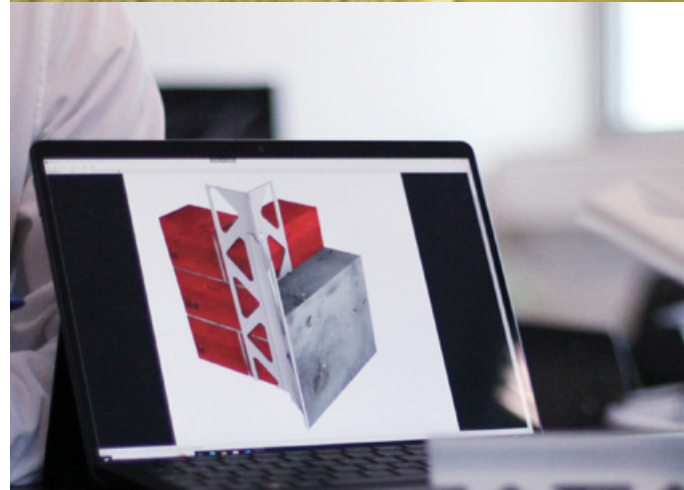
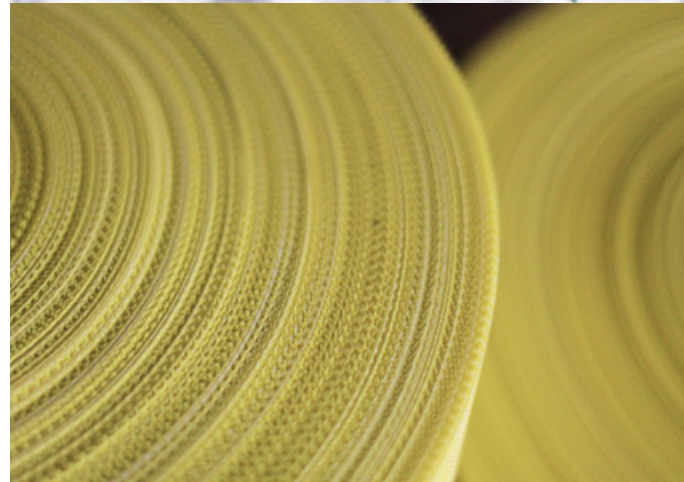





# INVESTMENT IN OUR PRODUCTION

**By replacing our punching tools with significantly more efficient rotary tools, we've not only achieved significant energy savings but also notably reduced noise in production. Profiles can now be identified by the "V" pattern in the perforation.**

In addition to the production of metal profiles, we also offer the entire range of boss profiles and molded parts. Our customers particularly appreciate the flexibility of our systems, which enable us to meet a wide range of customer requirements for special profiles.

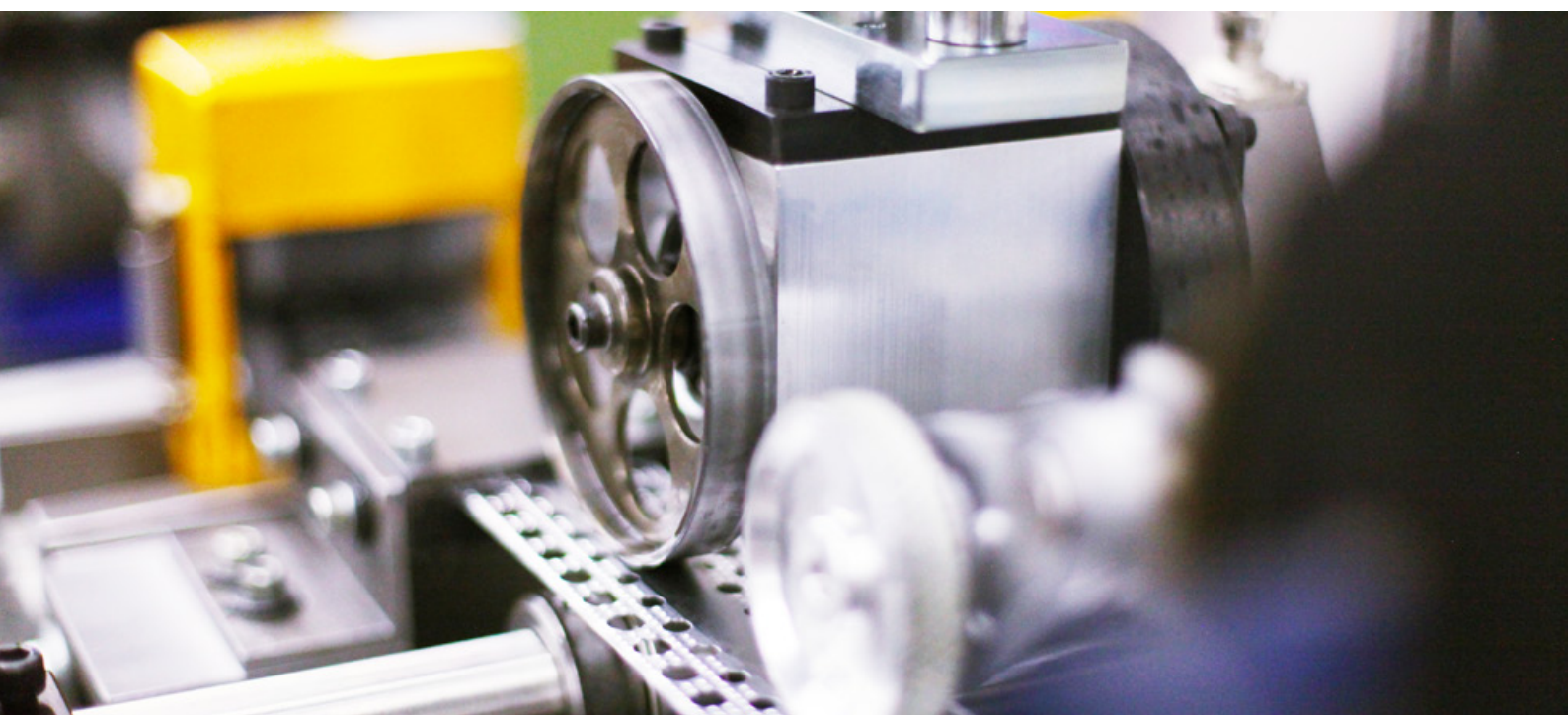

# VWS-PURE PRODUCT SERIES

In our sustainable product series, you will find exclusively items made from recycled materials. A significant step towards environmentally conscious construction.



## VWS PURE fabric corner angle: a step towards a green future

Our VWS-PURE fabric corner angle, made from recycled window profiles, combines innovation and sustainability in one product. With a production process that utilizes 100% green energy, we are setting new standards to minimize our carbon footprint. The commitment to sustainability extends to our packaging, which is made from recycled cardboard and paper tape to avoid plastic waste. Our product proves that high quality and active environmental protection can go hand in hand.

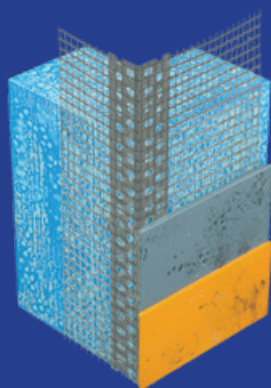
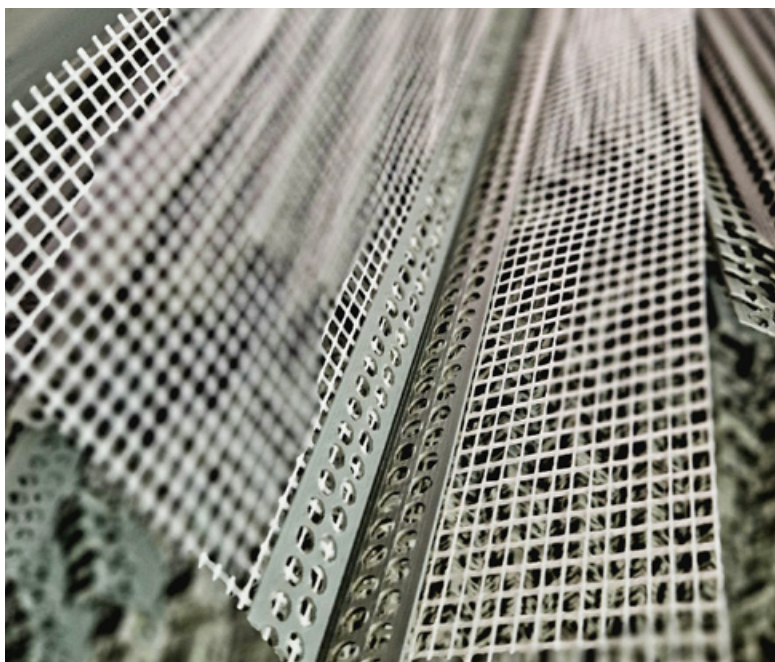

552001

## VWS-PURE Fabric Corner

The PVC tissue box angle marks the beginning of our new VWS-PURE series. Soon, you will find additional sustainable products for ETICS, plaster, and drywall.



# REVEAL PROFILES

VWS reveal profiles offer a wide range of applications from interior to exterior plastering, and from drywall to thermal insulation. We ensure quality through internal and external inspections conducted by ift Rosenheim.



**A profile for all cases: versatile, efficient, and aesthetic**

With two rebate edges, it can be used for 6mm and 9mm plaster thickness simultaneously. Whether you are working with a mineral or paste-based plaster system: you only need one profile. With the additional visible lip, you simultaneously achieve a beautiful, clean finish. The new combined reveal profile complements our range of reveal profiles.

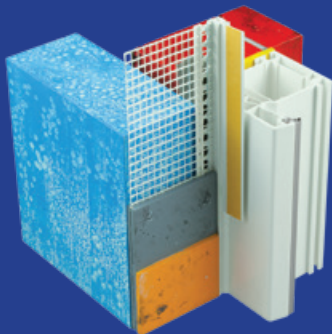
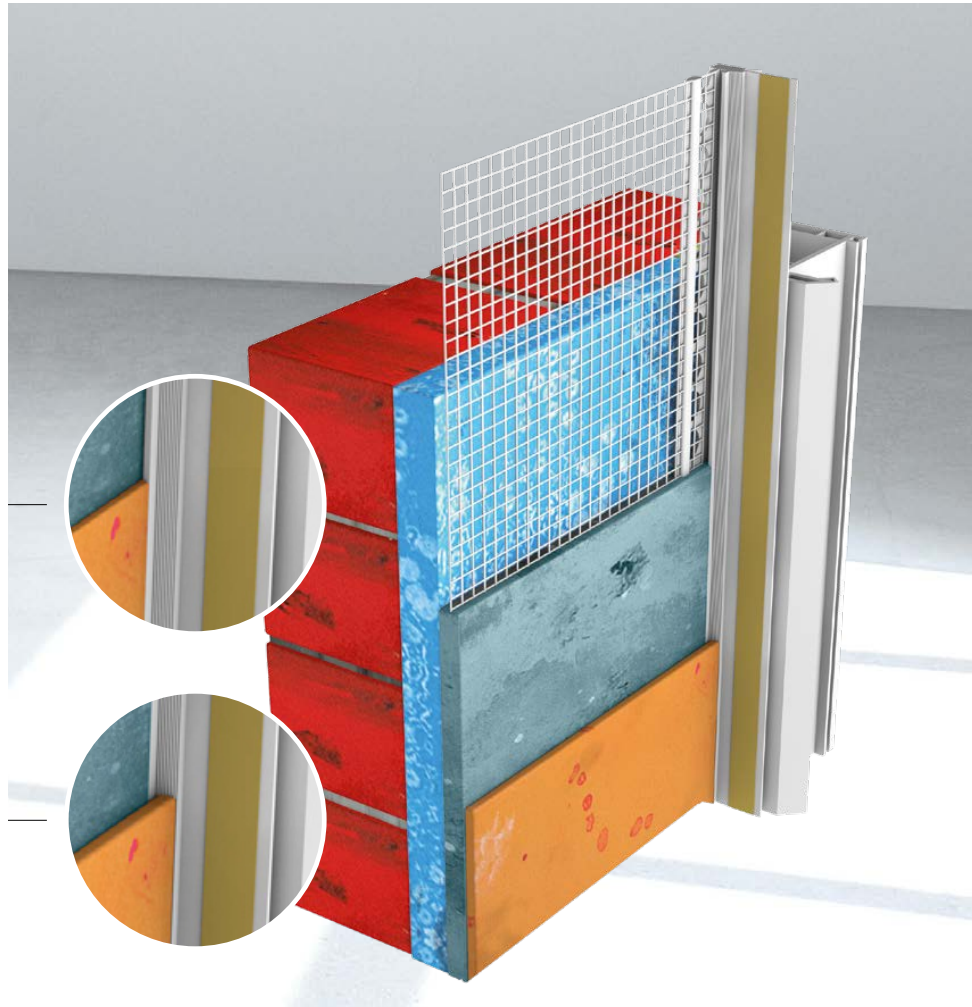

**644810**

## **Reveal Profile DYNAMIK**

Our patented 3D reveal profile 'Dynamik' impresses with high movement absorption in all directions, easy installation, and an affordable price. The technical properties of our 'Dynamik' profiles have been determined by an independent testing institute.





“ At VWS, customer satisfaction is the measure of success. With passion and expertise, we are dedicated to surpassing customer expectations.

Markus Bartelmuß, VWS Sales Management Export

### Expert advice

You will receive customized solutions and recommendations that meet your specific requirements.

### Always available

Our customer support is always available to address your concerns fast and professionally. Your satisfaction is our highest priority.



Competent employees in both indoor and outdoor service.



Regional contacts available on-site in the shortest time possible.



Continuous availability for our customers.



Partnerships with systems, cooperatives, and associations



In-house technical department available for inquiries.



Member of the European Association of Plaster Profile Manufacturers.

# THE “VWS CAMPUS”

At our “VWS CAMPUS”, you’ll find numerous expert tips and tricks about our products.

Take advantage of the training opportunities provided by our experts.



## TOPIC 1 DRYWALL PROFILES

If you want more than just simply erecting straight drywall walls, you can't overlook our PVC trowel profiles. Whether it's curves, expansion or shadow joints, or finishes, metal profiles quickly reach their limits here. Our specialists will show you what's possible with our high-quality PVC trowel profiles.



## TOPIC 2 Reveal Profiles

Here, you'll learn everything about the properties and applications of reveal profiles in plaster, drywall, and external thermal insulation systems (ETICS). With a focus on the renovation sector, our experts impart knowledge about an essential range of products.



## TOPIC 3 PLASTER PROFILES

How can I avoid rust problems, and what can PVC profiles do better than metal profiles? That's the focus of this training session for your employees and customers. Easier to work with, secure in processing, and applicable for all uses, these are our PVC plaster profiles.

Interested in a professional product training?

If you're interested in training, please register using the QR code below. We look forward to seeing you!



# LOGISTICS: GLOBALLY OPTIMIZED NETWORK

## VWS for seamless operations

The following core optimizations are part of our strategy to ensure efficient and sustainable logistics for our customers:

### Just-in-Time deliveries

Wir setzen auf punktgenaue Lieferungen, um Lagerkosten und Engpässe zu vermeiden.

### Efficient route planning

Precise route planning minimizes transportation distances, reduces costs, and cuts emissions.

### Digitalisation

The use of technology enables precise real-time monitoring and optimization of the supply chain.

### Inventory management

Optimized inventory management enables faster order processing and minimizes warehouse costs.



### Network

Globally optimized and reliable logistics network.



### Delivery Date

Orders for stock items placed by 10 am leave our premises on the same day.



### Warehouse

Over 650 different profiles permanently in stock.



### Direct

Deliveries to your customers or to the construction site are no problem.

## By optimizing delivery routes



# -100

Tons of CO<sub>2</sub> emissions saved per year



# -2000

Less truck kilometers daily



# SOCIAL RESPONSIBILITY

Social responsibility is ingrained in our corporate culture. We actively advocate for diversity and social cohesion. Firmly believing that companies bear a social responsibility, we contribute daily by supporting institutions and associations.



✓ **We support**  
workshops for the blind and other social institutions.

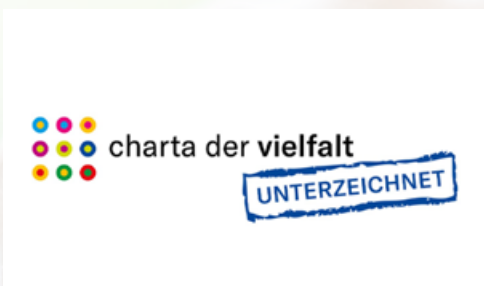

✓ **We sign**  
The Diversity Charter



✓ **We support**  
numerous local and national associations for years.



✓ **We save**  
26 jobs at Diakonie Reutlingen



**111200**  
PVC Perfect corner profile  
Dimensions 24 × 24 mm



**111400**  
GENIUS PVC round arch profile  
Dimensions 24 × 24 mm



**111300**  
PERFEKT PVC Lichtenstein profile  
Dimensions 14 × 23 mm



**156800**  
PERFEKT PVC Lichtenstein profile  
for round arches  
Dimensions 14 × 23 mm



**150200**  
Edge profile PVC L-shape  
Dimensions 12,5 mm

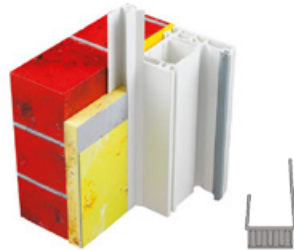

**160200**  
L-shaped PVC reveal profile  
Dimension 12.5 mm



**153300**  
Movement joint profile drywall construction  
Dimensions 48 mm for plasterboard panels

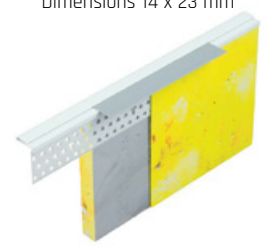

**156600**  
PVC end profile with removable cover  
strips 12,5 x 30 mm



**200600**  
10 mm PVC quick render profiles  
Dimensions 36 × 10 mm



**330700**  
Edge straightening profile S  
PVC White / plaster 14 mm  
Dimensions 40 × 40 mm



**343200**  
PVC D. PRO plinth end profile  
White 10 mm render  
Dimensions 10 × 38 mm



**341000**  
M PVC edge alignment profile  
White 10 mm render  
Dimensions 40 × 40 mm

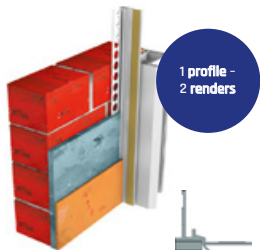

**646950**  
PVC combi reveal profile with lip  
6 and 9 mm render

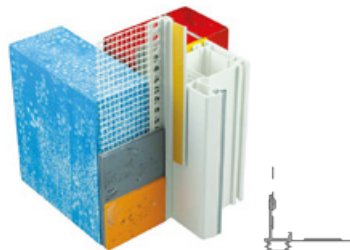

**644600**  
Accordion PVC reveal profile  
with mesh for 9 mm render

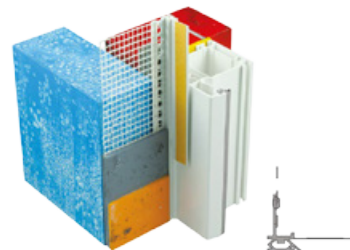

**644810**  
Reveal profile DYNAMIK PVC  
with mesh / dimensions 9 mm



**648501**  
Tropfkantenprofil PVC Exklusiv 5 mm  
mit Gewebe 10 × 10 cm weiß



**420200-422600**  
PVC - Premium profile  
Dimensions 40 - 240 mm



**630200**  
Horizontal movement  
joint profile



**640000**  
Attika PVC end profile  
with fabric

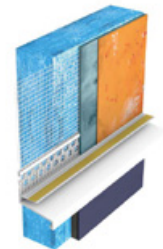

**640100**  
Transition profile for ETICS on  
ceramics

**VWS Befestigungstechnik GmbH**

Siemensstraße 2  
72805 Lichtenstein

Phone: +49 7129695-100

Mail: look@vws.de

[www.vws.de](http://www.vws.de)

